

INDUSTRIES SERVED

80/20 provides t-slotted extrusions that can adjust to fit any industry and application. From heavy to light-duty, 80/20 provides a secure and OSHA approved guard, display, workstation, etc. for your industry needs.

Machine Tool   Automation   Material Handling   Manufacturing   Retail Systems   Furniture   Fluid Power  
Robotics   Displays/Exhibits   Medical   Scientific   Packaging   Electronics

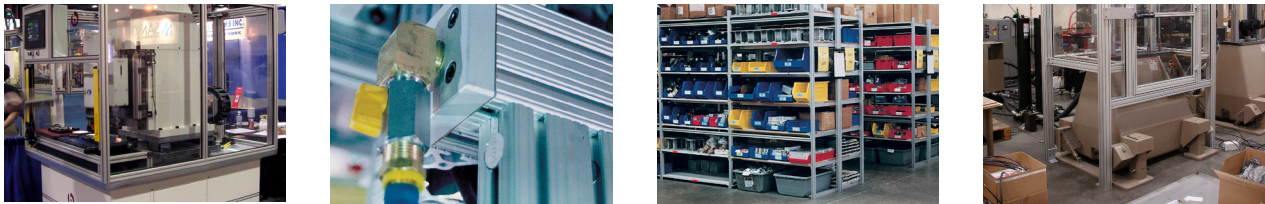

80/20® Inc.  
The *Industrial Erector Set*®

T-SLOTTED ALUMINUM FRAMING  
SYSTEMS ADJUST TO FIT ANY INDUSTRY

80% of your results come from 20% of your efforts

STRUCTURAL ALUMINUM BENEFITS

- No welding, priming or painting
- Lightweight and easy to machine
- Uses standard fractional or metric fasteners
- Less engineering time required
- Easy to fabricate – only simple hand tools required
- T-Slot technology is industry accepted
- Great aesthetic value
- No expensive fabricating equipment required
- Machine frames can be easily reconfigured for design changes



Photo courtesy of MTS Systems Corporation 2012



John Henry  
Foster



**JHFOSTER**  
John Henry Foster.com  
Automation • Robotics • Compressed Air • Service

# 80/20 ALUMINUM FRAMING SYSTEMS

Save money, keep the quality

For more than a decade, John Henry Foster (JHF) has offered customized 80/20 aluminum framing systems for some of the most complicated and mission-critical automation projects, as well as smaller applications requiring innovative solutions. Modular aluminum framing systems and integrated guarding have the capability to adjust to fit virtually any industry and application. These custom specific framing systems consist of aluminum profiles, fasteners and accessories and are fully equipped to handle projects ranging from light to heavy-duty. They provide secure and OSHA-approved guards, displays, workstations, or any other custom application needed.

## BENEFITS OF USING 80/20 FRAMING SYSTEMS

### UNLIMITED POSSIBILITIES

80/20 is your one-stop shop for all of your modular framing needs, supplying extruded profiles and the most diverse line of fasteners and accessories available. With 80/20 products you can truly think “outside the box” and bring your imagination to life.

### COST EFFECTIVE

80/20 aluminum framing systems could save you hundreds of dollars versus welding steel framing. 80/20 uses 6105-T5 aluminum, which has a yield strength of 35,000 psi and also has 1/3 the weight of iron, steel, copper and brass.

### STOCKED PARTS

80/20 stocks over 6000 standard parts serving virtually every industry and application today with many orders shipping out from 80/20 in 24 hours or less.

### DESIGN ASSISTANCE

JHF provides design assistance using AutoCAD™and SolidWorks™. All that is needed for us to start your design is a sketch of your project and dimensions.

### DROP-LOCK FEATURE AVAILABLE

The drop-lock consists of a 2° decline of the T-slot flange. When a fastener is tightened to (or beyond) the necessary torque, the flange will flex up to the adjoining profile, thus creating pressure which prevents the fasteners from vibrating loose.

### KIT PACKAGING

Reduce time and money by pre-packaging your project at no extra charge. Profiles are cut to length, machined and come ready to assemble with all necessary hardware.

### ASSEMBLY

Together, the teams at 80/20®, Inc. and JHF can build your project no matter what application you choose. You'll receive quality-built frames set to your exact specifications.

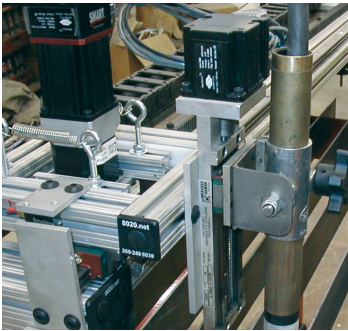
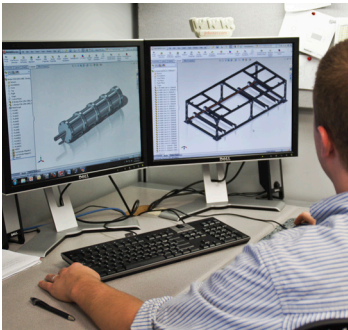

## EXPERIENCE THE DIFFERENCE

### DESIGN ASSISTANCE

To help save time and money, JHF offers services such as design assistance, custom machining, kit packaging and support to build your application, in addition to offering the necessary parts and pieces for your project. Our design engineers are able to create customized systems, plus provide AutoCAD™ and SolidWorks™ drawings of the specified application, along with a bill of materials. They partner with clients to determine their needs, provide options and recommendations, place the order for the specified kit, and if needed, support the installation.

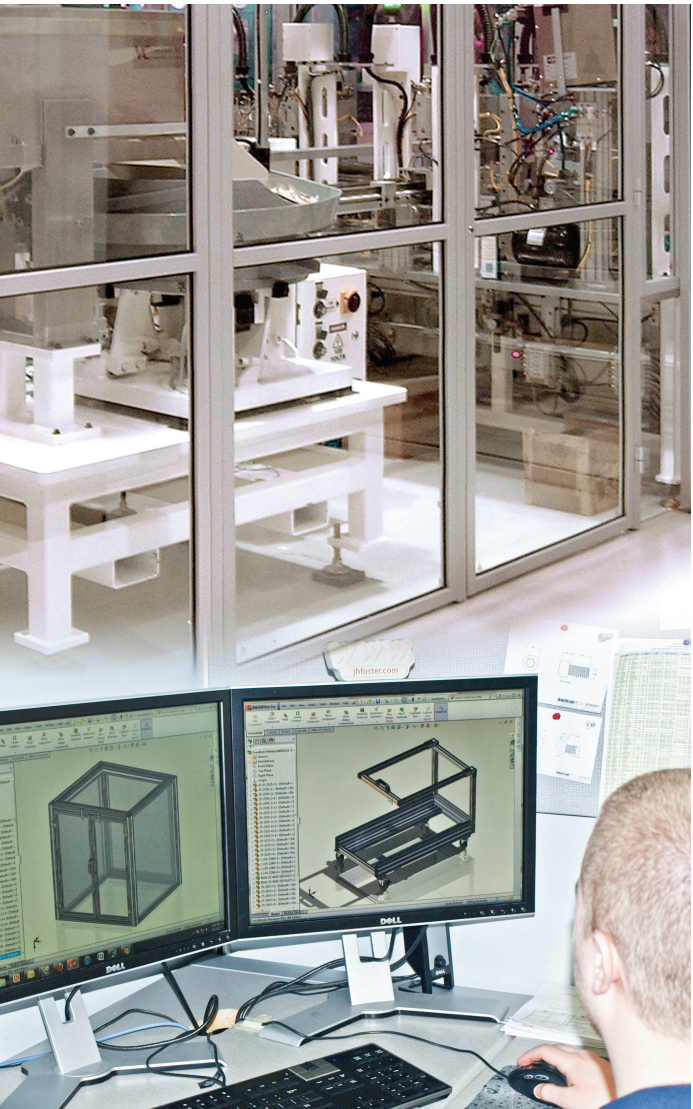

John Henry Foster (JHFoster) is a leading distributor and service provider for automation and compressed air systems. Our mission is to assist companies like yours automate their manufacturing applications to make the process a positive journey. We are committed to providing successful solutions that exceed production demands, reduce costs, and increase overall efficiencies.

Headquartered in Eagan, MN, with a location in Fargo, ND, we also offer a fully-equipped team of mobile technicians that provide service to the 5-state area. Contact us today at 800.582.5162 or [jhfooster.com](http://jhfooster.com) to learn more about how you might benefit from knowing us.

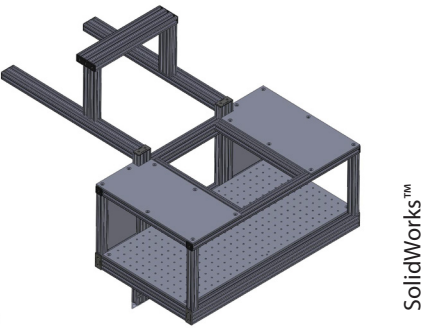
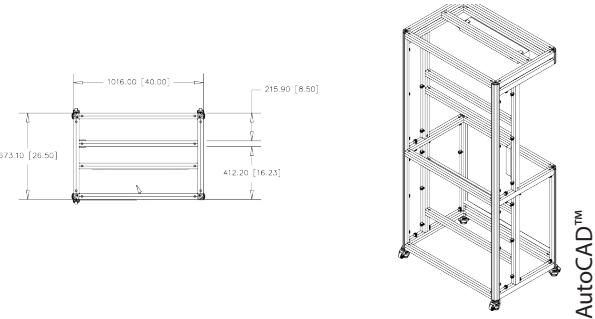

## OUR DESIGN ENGINEER & SPECIALISTS

TERRY FLANAGAN, 80/20 DESIGN ENGINEER

651.681.5750

[terry.flanagan@jhfooster.com](mailto:terry.flanagan@jhfooster.com)

TOM GARDING, 80/20 DESIGN SPECIALIST

651.681.5751

[tom.garding@jhfooster.com](mailto:tom.garding@jhfooster.com)

ISAAC TREXEL, 80/20 DESIGN SPECIALIST

651.994.7349

[isaac.trexel@jhfooster.com](mailto:isaac.trexel@jhfooster.com)

John Henry Foster

3103 Mike Collins Drive

Eagan, MN 55121

[jhfooster.com](http://jhfooster.com)